

Datasheet FT-95405

PARRAC99 code 95405: Galvanized-steel made clamp used for connecting 30x2mm flat & round down conductor on metallic frames.

Last edited on 01/04/2016

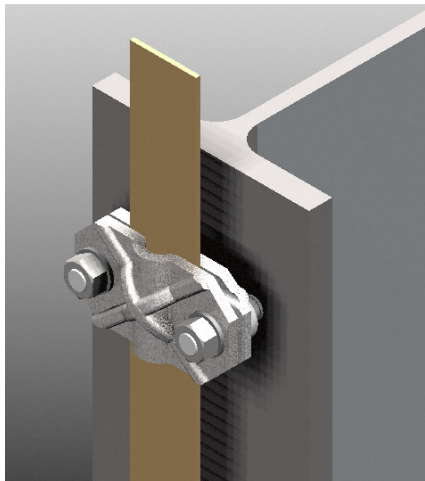

Designation

Galvanized-steel made clamp to be used for connecting 30x2mm flat & round down conductors or metal braids on metallic frames.

Technical features

Dimensions : 60L x 30W x 25H mm

Unit weight: 0.12 kg

Material: galvanized steel

Delivered in a single package with screws

Mise en Œuvre

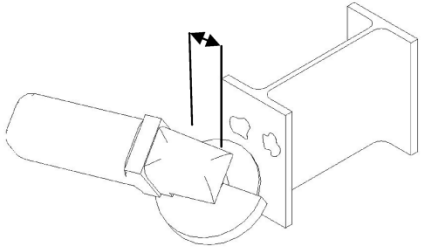
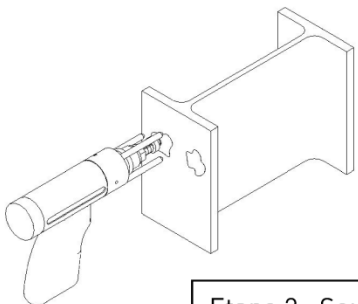
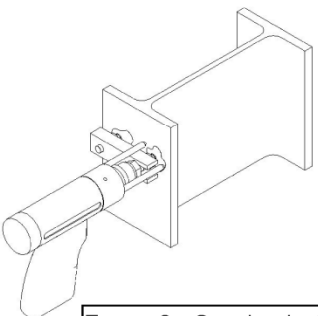
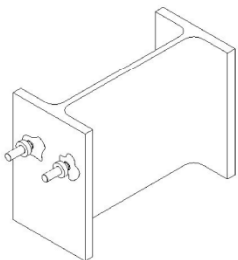
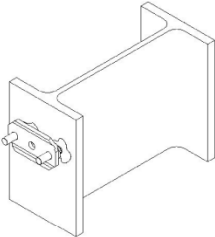
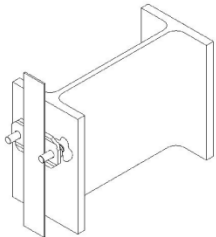
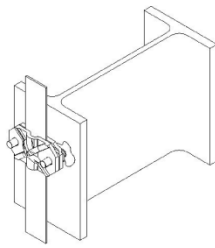
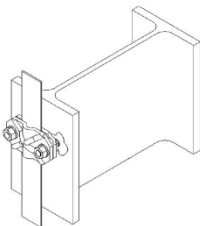
 <p>Etape 1 : Meuler 2 surfaces distantes d'environ 5 cm</p>	 <p>Etape 2 : Souder le 1^{er} goujon bi-métal</p>
 <p>Etape 3 : Souder le 2^{ème} goujon Bi-métal avec le gabarit pour Respecter l'entraxe de 50 mm</p>	 <p>Etape 4 : Retirer le gabarit de soudage.</p>
 <p>Etape 5 : Monter la base du support paratonnerre</p>	 <p>Etape 6 : Monter le ruban de mise à la</p>
 <p>Etape 7 : Monter la bride du support paratonnerre</p>	 <p>Etape 8 : Monter les rondelles Ø8 et serrer avec les 2 écrous M8</p>